

# EASY PARKING LIVE



With **Easy Parking Live**, the garage door opens automatically when the vehicle arrives, no need to touch your phone. Available for android and iOS and compatible with Siri and Google Assistant for voice opening.

Además, **Easy Parking Live** incluye conexión Bluetooth y Wifi, para que puedas abrir la puerta desde cualquier lugar.

Thanks to the Hub with camera, with **Easy Parking Live** you can see live from your mobile phone who enters the garage.

## CONTENTS

### Includes:

- 1 Actuator device
- 1 Antenna
- 1 Hub with camera
- 1 Power supply for Hub
- 1 Power supply for actuator

### Herramientas de instalación:

- 1 circular plates and screws
- Adhesives

## HUB CON CÁMARA

### TECHNICAL SPECIFICATIONS:

#### Power supply

- AC-DC adapter (230V - 5V, maximum current 2.4A).
- Lithium battery 1200 mAh.

#### Consumption

- Average unit power consumption <3 W.
- Maximum power consumption <6 W.

#### Connectivity

Bluetooth Low Energy (BLE) version 4.0 (Class 1) connection.

- Frequency band 2.4 ~ 2.48 GHz.
- Maximum power 20 dBm.
- Maximum range 100 m.

Wifi connection

Ethernet connection via RJ45 connector

## HUB WITH CAMERA

### TECHNICAL SPECIFICATIONS:

- Supply voltage: 18-48 VDC / 24-36 VAC
- Consumption: 360mW
- Maximum relay current: 10A
- Maximum relay voltage: 48V
- Communication technology: Bluetooth
- Maximum emission power:: 20dBm
- Power supply: In:230V, out:24VDC

# EASY PARKING LIVE

Installation by a professional is recommended. The actuating device must not be wetted or come into direct contact with water. Install it inside the engine control panel.

## QUICK INSTALLATION GUIDE

### INSTALLATION:

- Install the actuator device.
- Connect the antenna to the actuator device.
- Connect the camera to the power supply
- Switch on the camera
- 

### LINK TO THE APPLICATION:

- Download the EVEROU app and register.
- Select Access category
- Press the actuator button for 3 seconds
- Add device
- Select the Security category
- Press the camera button for 3 seconds
- Add device
- Connect the camera to the wifi or cable

### TERMINAL BLOCK

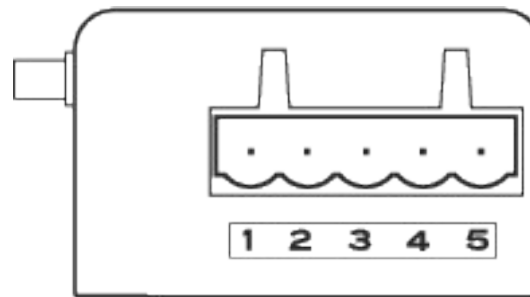

PINOUT TERMINAL BLOCK DESCRIPTION	
1	+24V
2	GND
3	Output Circuit
4	Input Circuit
5	No connection

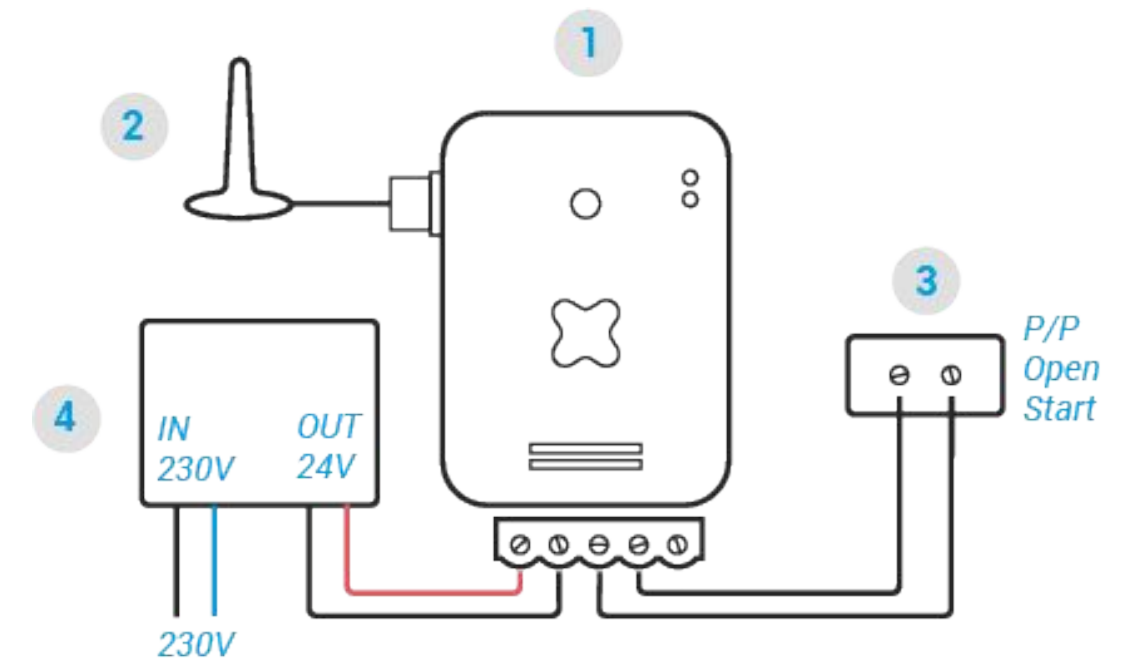

- 1 Actuator device
- 2 Antenna
- 3 Motor control board
- 4 Power supply

